

ALPHA 10 - AP2XXXX1

IP rated downlights
design Roberto Mantovani

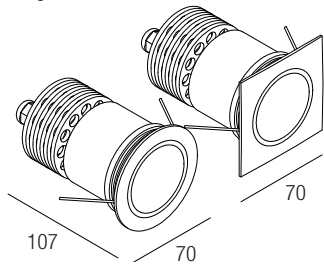

I ISTRUZIONI PER LE AUTORITÀ PREPOSTE ALLA SORVEGLIANZA DEL MERCATO SULLA RIMOZIONE DELLA SORGENTE LUMINOSA E DELLE UNITÀ DI ALIMENTAZIONE SEPARATA
GB INFORMATION FOR MARKET SURVEILLANCE AUTHORITIES ON REMOVAL OF LIGHT SOURCE AND SEPARATE CONTROL GEAR

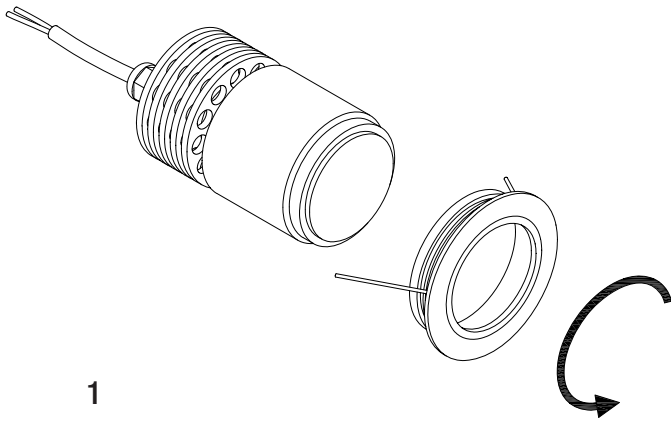

1
I Svitare la parte frontale.
GB Unscrew the front part.

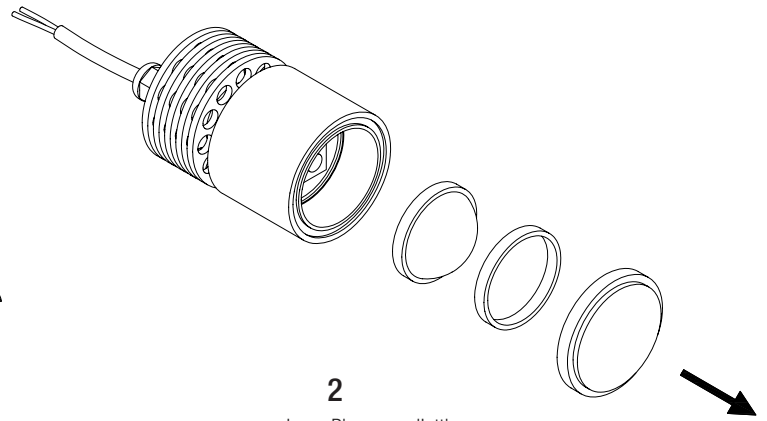

2
I Rimuovere l'ottica.
GB Remove the optic.

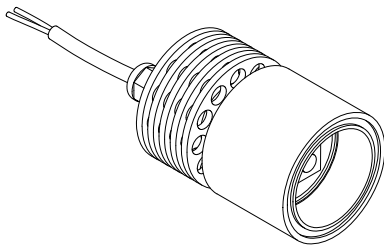

3
I Sorgente luminosa ispezionabile.
GB Examinable light source.