

BULL 40 - BU4XXXXX

Projector for 230VAC track

design Lapo Grassellini

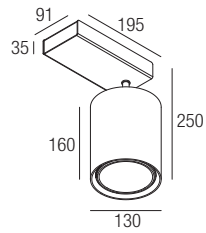

I ISTRUZIONI PER LE AUTORITÀ PREPOSTE ALLA SORVEGLIANZA DEL MERCATO SULLA RIMOZIONE DELLE UNITÀ DI ALIMENTAZIONE SEPARATA
GB INFORMATION FOR MARKET SOURVEILANCE AUTHORITIES ON REMOVAL OF SEPARATE CONTROL GEAR

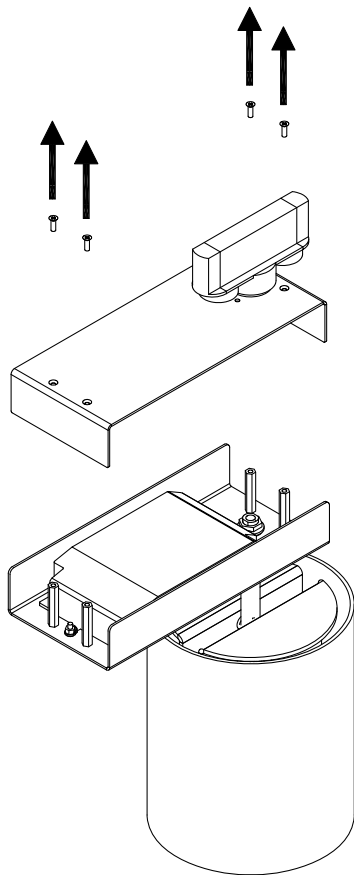

1

I Svitare le viti e rimuovere la lamiera superiore.
GB Unscrew the screw and remove the metal sheet on the top.

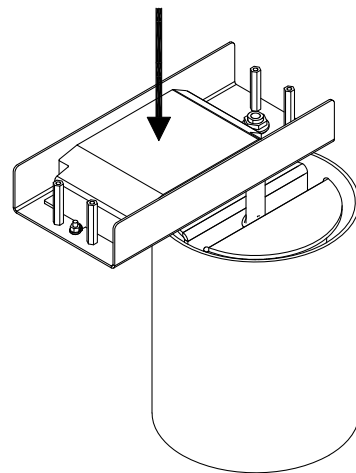

2

I Driver ispezionabile.
GB Examinaable driver.

I ISTRUZIONI PER LE AUTORITÀ PREPOSTE ALLA SORVEGLIANZA DEL MERCATO SULLA RIMOZIONE DELLA SORGENTE LUMINOSA

GB INFORMATION FOR MARKET SURVEILLANCE AUTHORITIES ON REMOVAL OF LIGHT SOURCE

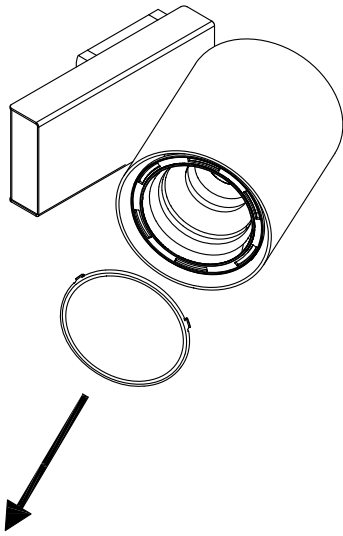

1

I Rimuovere lo schermo.
GB Remove the screen.

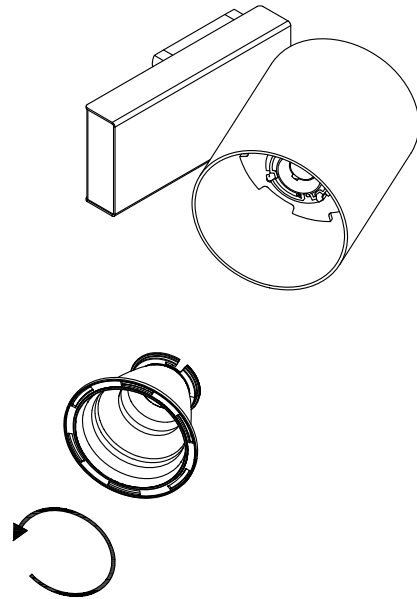

2

I Ruotare la lente e rimuoverla.
GB Rotate the optic and remove it.

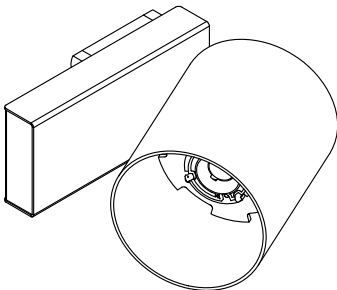

3

I Sorgente luminosa ispezionabile.
GB Examinable light source.