

FLY 10 - FLY1XXXXX

Flush optic IP Rated downlights

design Rod&Todd

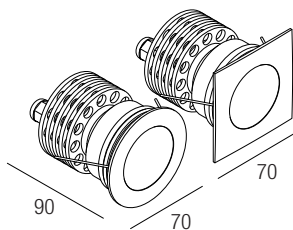

I INFORMAZIONI SULLA RIMOZIONE DELLA SORGENTE LUMINOSA DAL PRODOTTO CONTENITORE A FINE VITA

GB INFORMATION ON REMOVAL OF LIGHT SOURCE FROM CONTAINING PRODUCT AT END OF LIFE

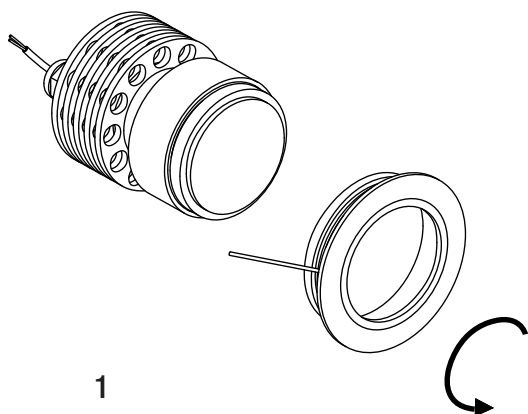

1
I Svitare la parte frontale.
GB Unscrew the front part.

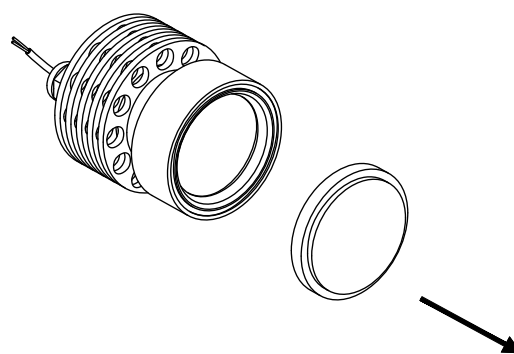

2
I Rimuovere lo schermo.
GB Remove the screen.

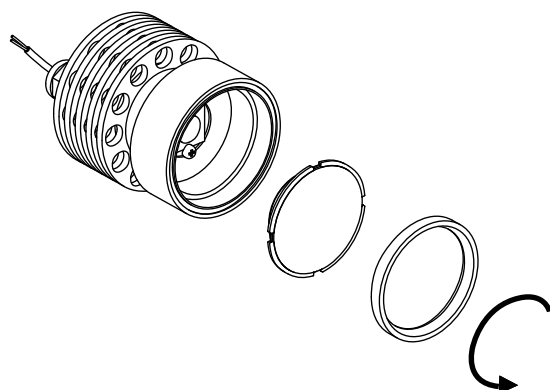

3
I Svitare il fermalente e rimuovere la lente.
GB Unscrew the locking ring and remove the optic.

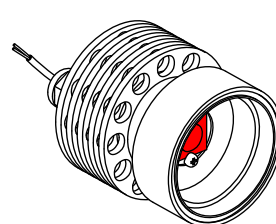

4
I Rimuovere la sorgente luminosa.
GB Remove light source.