

## HAP 140 - HP14XXXX

Recessed optic downlights

design Lapo Grassellini

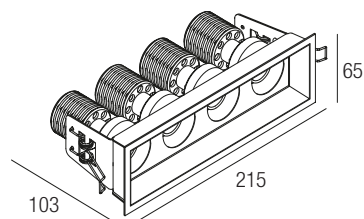

I INFORMAZIONI SULLA RIMOZIONE DELLA SORGENTE LUMINOSA DAL PRODOTTO CONTENITORE A FINE VITA

GB INFORMATION ON REMOVAL OF LIGHT SOURCE FROM CONTAINING PRODUCT AT END OF LIFE

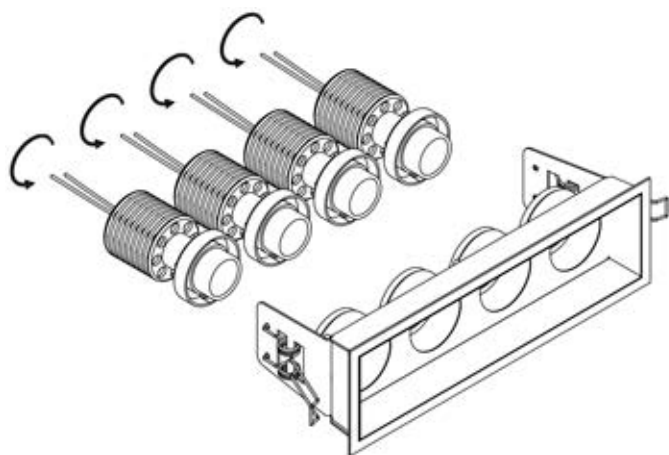

1

I Svitare i corpi retrostanti e separarli dalla parte frontale.

GB Unscrew the rear bodies and separate them from the front part.

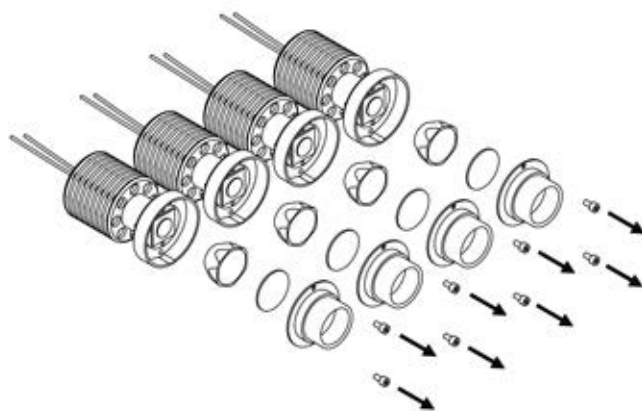

2

I Svitare la viti e rimuovere le ottiche.

GB Unscrew the screws and remove the optics.



3

I Rimuovere le sorgenti luminose.

GB Remove light sources.