

## HERO 20 - H2XXXXX

Flush optic downlights

design Lapo Grassellini

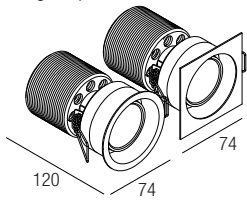

I ISTRUZIONI PER LE AUTORITÀ PREPOSTE ALLA SORVEGLIANZA DEL MERCATO SULLA RIMOZIONE DELLA SORGENTE LUMINOSA E DELLE UNITÀ DI ALIMENTAZIONE SEPARATA  
GB INFORMATION FOR MARKET SURVEILLANCE AUTHORITIES ON REMOVAL OF LIGHT SOURCE AND SEPARATE CONTROL GEAR

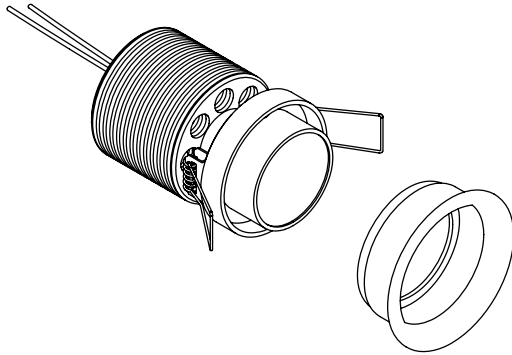

1

I Svitare la parte frontale.  
GB Unscrew the front part.

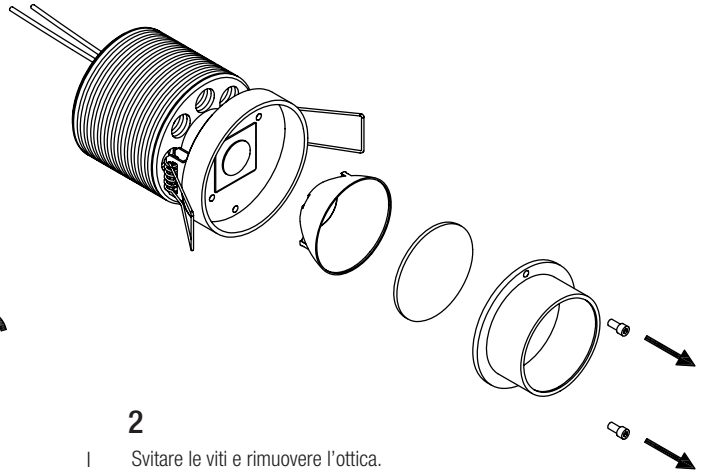

2

I Svitare le viti e rimuovere l'ottica.  
GB Unscrew the screw and remove the optic.

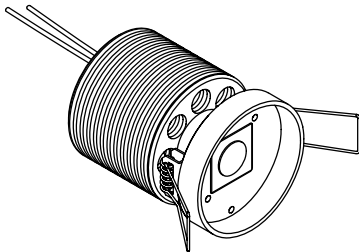

3

I Sorgente luminosa ispezionabile.  
GB Examinable light source.