

## KOINE 10 - KHXXXX

Ceiling mounted luminaires

design Roberto Mantovani

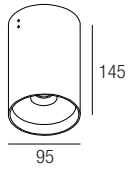

I ISTRUZIONI PER LE AUTORITÀ PREPOSTE ALLA SORVEGLIANZA DEL MERCATO SULLA RIMOZIONE DELLE UNITÀ DI ALIMENTAZIONE SEPARATA

GB INFORMATION FOR MARKET SURVEILLANCE AUTHORITIES ON REMOVAL OF SEPARATE CONTROL GEAR

I **NOTA** - SOLO VERSIONE AC

GB **NOTE** - AC VERSION ONLY

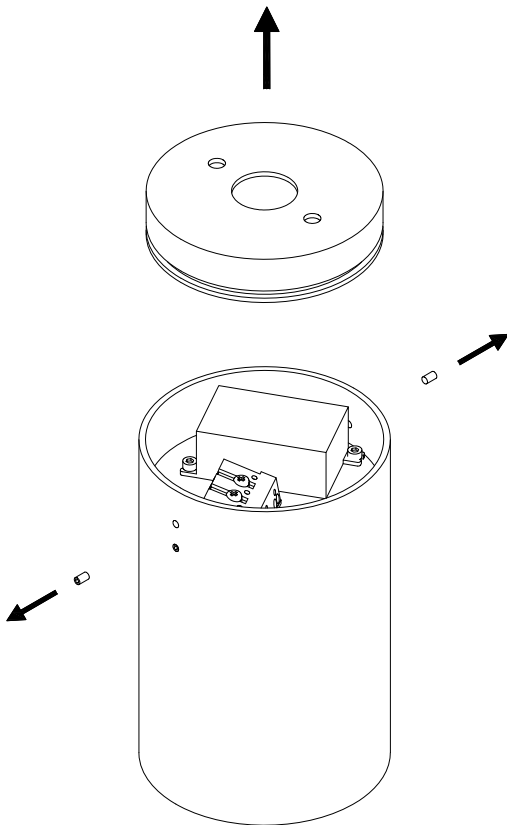

1

I Svitare i grani superiori e rimuovere l'anello.

GB Unscrew the upper screws and remove the ring.

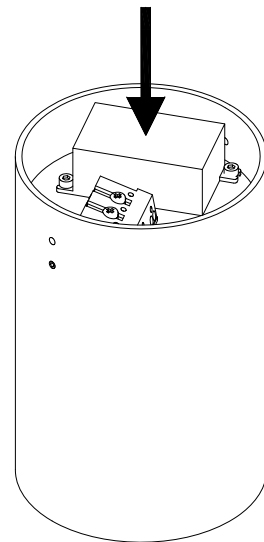

2

I Unità di alimentazione ispezionabile.

GB Examinable control gear.

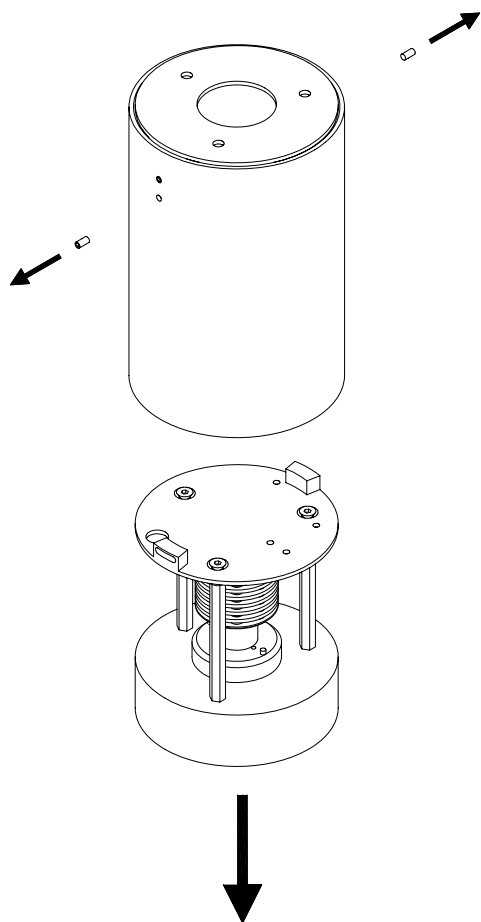

**1**

- I Svitare i grani inferiori e rimuovere i componenti interni.  
GB Unscrew the bottom screws and remove the inner components.

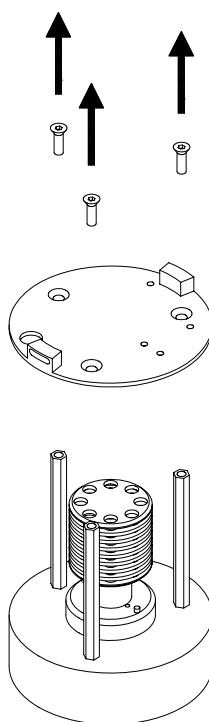

**2**

- I Svitare le viti per rimuovere la lamiera superiore.  
GB Unscrew the screws to remove the sheet metal on the top.

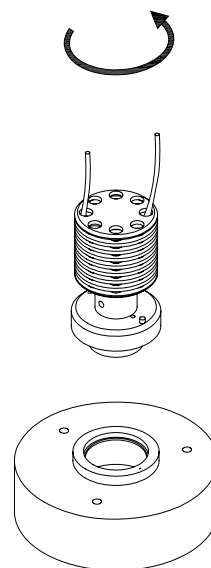

**3**

- I Svitare l'apparecchio luminoso per rimuoverlo.  
GB Unscrew the lighting fixture to remove it.

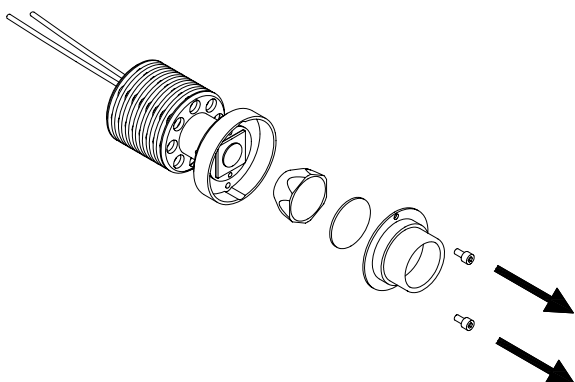

**4**

- I Svitare le viti e rimuovere l'ottica.  
GB Unscrew the screws and remove the optic.

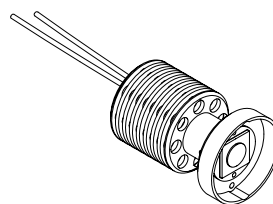

**5**

- I Sorgente luminosa ispezionabile.  
GB Examinable light source.