

LOREN 10 - LR1XXXX

Flush optic downlights

design Lapo Grassellini

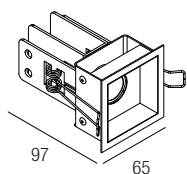

I ISTRUZIONI PER LE AUTORITÀ PREPOSTE ALLA SORVEGLIANZA DEL MERCATO SULLA RIMOZIONE DELLA SORGENTE LUMINOSA E DELLE UNITÀ DI ALIMENTAZIONE SEPARATA
GB INFORMATION FOR MARKET SURVEILLANCE AUTHORITIES ON REMOVAL OF LIGHT SOURCE AND SEPARATE CONTROL GEAR

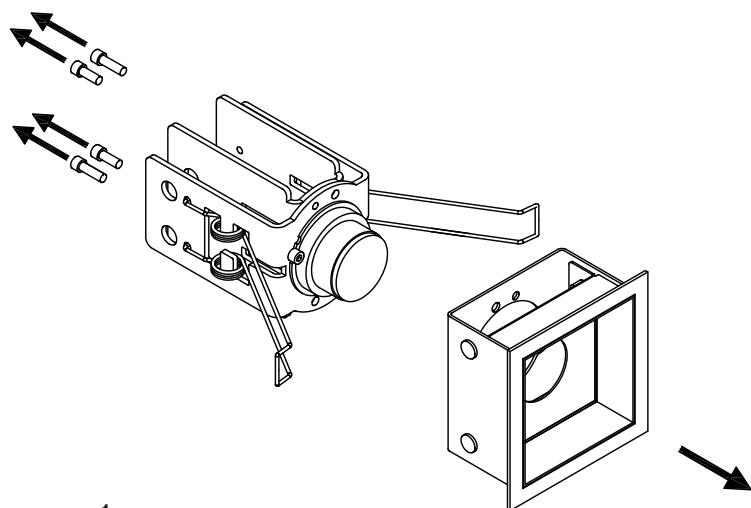

1

I Svitare le viti e rimuovere la parte frontale.
GB Unscrew the screws and remove the front part.

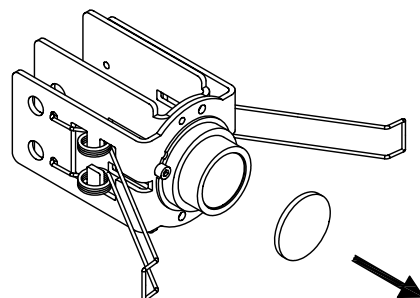

2

I Rimuovere lo schermo.
GB Remove the screen.

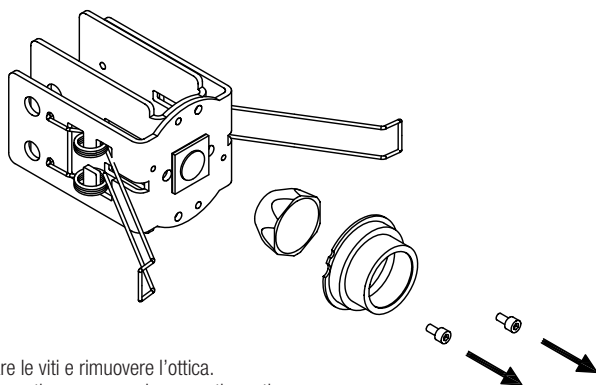

3

I Svitare le viti e rimuovere l'ottica.
GB Unscrew the screws and remove the optic.

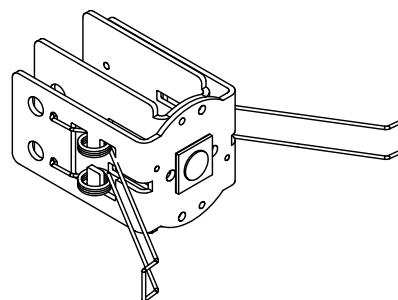

4

I Sorgente luminosa ispezionabile.
GB Examable light source.