

MAL 20 - MA2XXX

Uplights - Wallwasher

design Lapo Grassellini

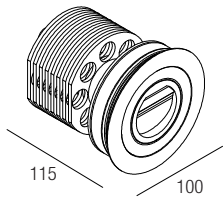

I ISTRUZIONI PER LE AUTORITÀ PREPOSTE ALLA SORVEGLIANZA DEL MERCATO SULLA RIMOZIONE DELLA SORGENTE LUMINOSA E DELLE UNITÀ DI ALIMENTAZIONE SEPARATA
GB INFORMATION FOR MARKET SURVEILLANCE AUTHORITIES ON REMOVAL OF LIGHT SOURCE AND SEPARATE CONTROL GEAR

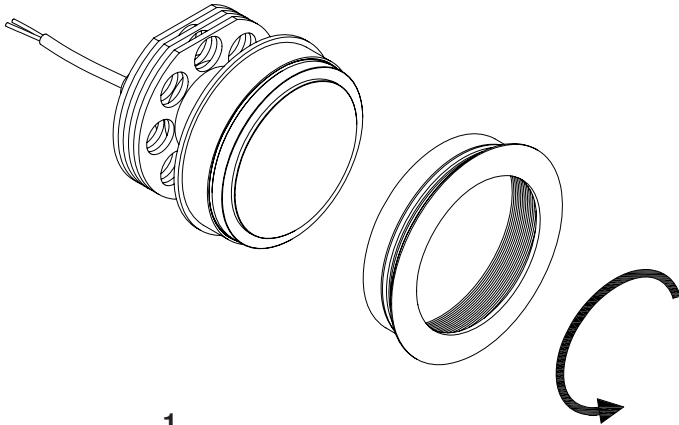

1
I Svitare l'anello frontale.
GB Unscrew the front ring.

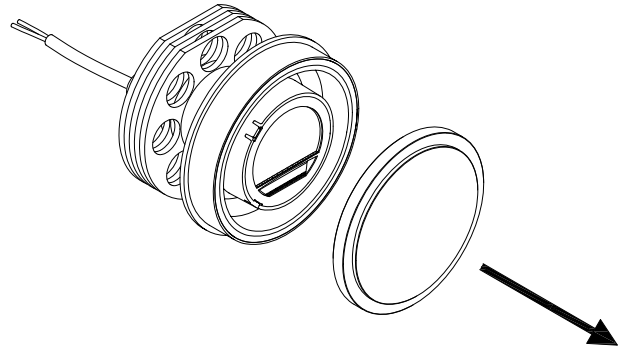

2
I Rimuovere lo schermo.
GB Remove the screen.

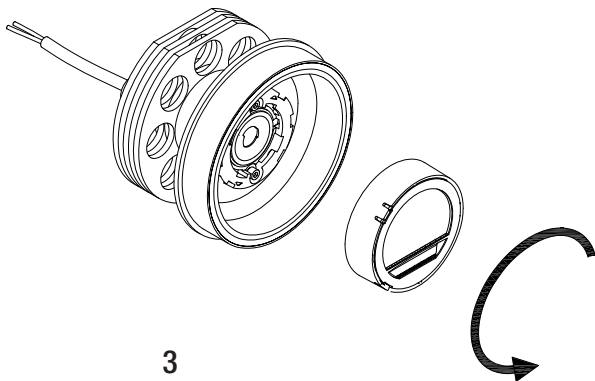

3
I Ruotare la lente e rimuoverla.
GB Rotate the optic and remove it.

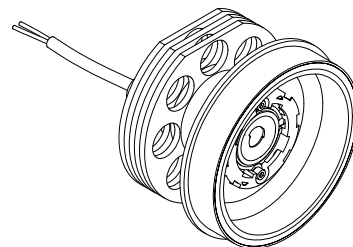

3
I Sorgente luminosa ispezionabile.
GB Examinable light source.